

EXTENSION PIECE F30

TECHNICAL DATASHEET

SPECIFICATIONS

Consists of 1 piece with 30 reinforcement ribs at the upper inside and 20 reinforcement ribs at the lower inside and a recess. It has a groove to be able to block the part. Up to 9 F30 extensions can be stacked on top of each other.

| | |
|----------------|------------------|
| Color | Black |
| Height | 30 mm 1,18 in |
| Upper diameter | 70 mm 2,76 in |
| Lower diameter | 62 mm 2,44 in |
| Weight | 41 g/piece |

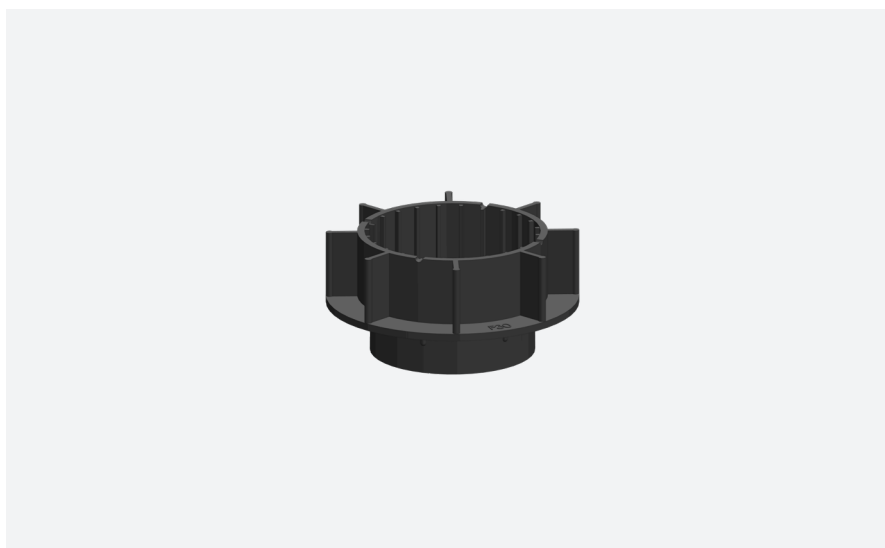

Recycled material



Weatherproof



Resistant to temperatures between -25 and +70°C



PP compound



Tested on Broof T4 and BFL-S1

PEDESTALS

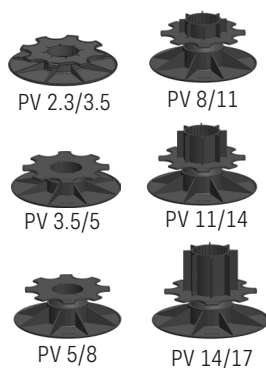

ACCESSORIES

Extension piece



AF100

Slope corrector



HS2



HA5

Fitting pieces



1 - 3 mm
1/32 - 1/8 in

PACKAGING

Bag

Dimensions 1.450 x 750 mm
57,09 x 29,53 in

Bruto weight 11 kg
Quantity 250 pieces/bag

Pallet

Dimensions 1.200 x 1.100 x 2.000 mm
47,24 x 43,31 x 78,74 in

Bruto weight 208 kg
Quantity 16 pieces/bag - 4.000 pieces

DRAWING

1.610 kg

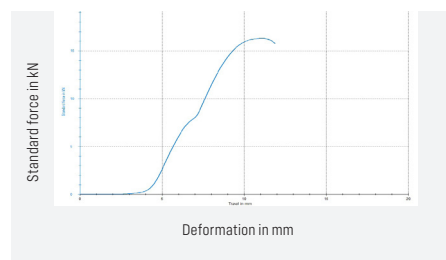

Discover here our contribution to a sustainable world:

